

## 8 thru 25 Amp TRIACs in a TO-220FP Full PAK

### CQ220-8MFP Series

#### features →

- Fully isolated plastic case. (no mica insulator required)
- 8, 12, 16 and 25 Amps
- 600 and 800 Volts

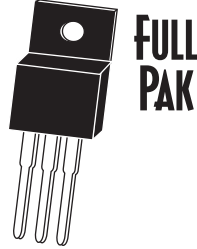

#### description →

The CENTRAL SEMICONDUCTOR CQ220-8MFP series types are Epoxy Molded Silicon TRIACs designed for full wave AC control applications featuring gate triggering in all four (4) quadrants. The fully isolated plastic case requires no additional insulation for mounting.

For more information on this series or on any other thyristor manufactured by Central™, visit: [www.centalsemi.com/thyristors](http://www.centalsemi.com/thyristors)

Sample Devices available upon request.

### selection guide

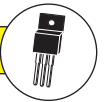

$I_T$ (AMPS)	8.0	12	16	25
@ $T_C$ (°C)	90	90	90	90
$I_{TSM}$ (AMPS)	50	80	110	150
$V_{DRM}, V_{RRM}$ (VOLTS)				
600	CQ220-8MFP	CQ220-12MFP	CQ220-16MFP	CQ220-25MFP
800	CQ220-8NFP*	CQ220-12NFP*	CQ220-16NFP*	CQ220-25NFP*

$I_{GT\ QI}$	20mA	20mA	25mA	30mA
$I_{GT\ QII}$	20mA	20mA	25mA	30mA
$I_{GT\ QIII}$	20mA	20mA	25mA	30mA
$I_{GT\ QIV}$	50mA	50mA	75mA	60mA
$V_{GT\ QI-QIII}$	1.5V	1.5V	1.5V	1.5V
$V_{GT\ QIV}$	2.5V	2.5V	2.5V	2.5V
$I_H$	25mA	25mA	25mA	50mA

\* 800 volt devices are available on request. Please consult factory.

# 8 thru 25 Amp TRIACs in TO-220FP Full PAK

## Mechanical Specifications - TO-220FP

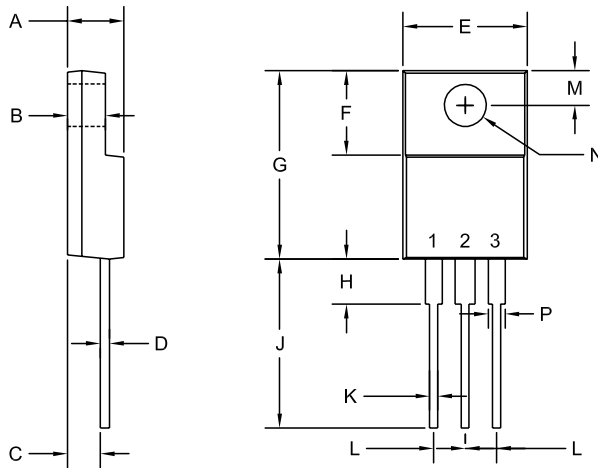

SYMBOL	INCHES		MILLIMETERS	
	MIN	MAX	MIN	MAX
A	0.180	0.190	4.57	4.83
B	0.101	0.111	2.57	2.83
C	0.099	0.103	2.51	2.62
D	0.018	0.025	0.45	0.63
E	0.408	0.418	10.37	10.63
F	0.238	0.258	6.06	6.56
G	0.625	0.635	15.86	16.12
H	0.125	0.135	3.18	3.43
J	0.530	0.540	13.46	13.72
K	0.026	0.031	0.65	0.79
L	0.100		2.54	
M	0.124	0.128	3.15	3.25
N (DIA)	0.116	0.119	2.95	3.03
P	0.048	0.053	1.23	1.36

TO-220FP (REV: R2)

R2

### Packing Information

#### Standard: Bulk

Devices are bulk packed in white corrugated box with black conductive coating (surface resistivity of  $<10^5$  ohms per square).

**Standard Packing Quantity: 500**

**Sleeve Packing Quantity: 50**

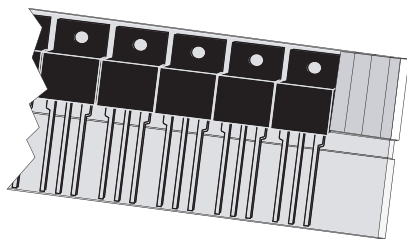

TO-220FP Antistatic Sleeve

### Lead Code:

#### TRIAC

- 1) MT1
- 2) MT2
- 3) GATE

For more information on this product please visit: [www.centrasemi.com](http://www.centrasemi.com)

**Central**<sup>TM</sup>  
Semiconductor Corp.

*Innovations in Discrete  
Semiconductors*

For further information contact:  
Sales at Central Semiconductor Corp.  
(631) 435-1110 or visit our website at:  
[www.centrasemi.com](http://www.centrasemi.com)

145 Adams Avenue • Hauppauge • New York • 11788 • USA • Tel:(631) 435-1110 • Fax: (631) 435-1824

PA FullPAK Triac